



D E L T A

KATYA

THE INSPIRATION BEHIND KATYA WAS TO CREATE A YACHT THAT CELEBRATED THE TIMELESSNESS OF CLASSIC SOPHISTICATION WHILE BEING EXTRAORDINARILY STATE OF THE ART.





A THOROUGHLY MODERN CLASSIC

From first glance, *Katya* is a striking beauty – a symphony of curves and shapes stunningly chic, yet magnificently timeless. This 151-foot full-displacement motor yacht utilizes the most advanced composite technology and naval architecture. She's the fifth yacht built out of Delta's proven full-displacement design and is both Lloyd's and MCA classed. Styled by the in-house Delta Design Group – who is also responsible for the entire engineering package – her striking exterior is dominated by a long, raised sheer line with a gentle, graceful slope. From every vantage point, *Katya* is sure to enchant all who make her acquaintance.

DELTA USED THE MOST ADVANCED THREE-DIMENSIONAL SURFACE MODEL TECHNOLOGY TO CREATE KATYA'S APPEALING LINES THAT ARE AT ONCE EXPLICIT AND PRECISE, YET INTEGRATE FLUID FORM AND FIGURES



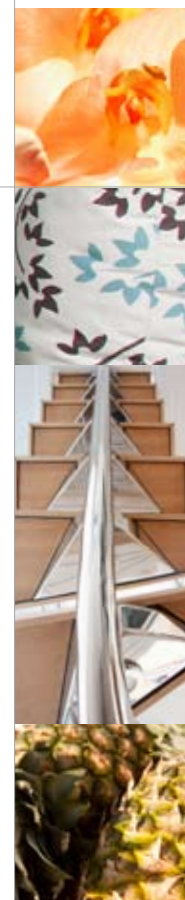

SURROUNDING BRILLIANCE

OUTDOORS

The outdoor spaces of *Katya* beg to be explored and enjoyed, beckoning all onboard to enjoy the panoramic views. Teak decks stretch as far as the eye can see, delighting guests throughout her three levels, from the swim platform to the sun deck. An ingenious tender garage is perfectly positioned aft, creating more wide-open areas for outdoor entertainment. Spirited furnishings in a handsome mix of red, teal and khaki create brilliant pops of color and are nicely juxtaposed against her warm white topsides.

THE MAIN AND UPPER DECKS FEATURE HANDSOME SHADED DINING TABLES THAT SEAT TEN



Katya



SOAK IN THE PLEASURE

The epicenter of outdoor delights can be found high above *Katya* on the sun deck. Primed with every possible amenity, there's very little reason to take the fun indoors. Just below a gracefully sculptural arch is a full wet bar and an ample grill. Ingenious one-piece fiber canopies that come in two sheer weights stretch the breadth and width of the decks to provide the optimal amount of sun or shade. Forward on the sundeck is a luxurious hot tub on a raised platform, the perfect spot to luxuriate in the breeze after mornings playing in the waves – and the ideal locale to gently ease into an enchanted evening at sea.

FRAMING THE SUN DECK IS A CARBON FIBER ARCH THAT
CLEVERLY HOUSES KATYA'S VITAL COMMUNICATIONS
SYSTEMS WHILE ADDING TO HER DRAMATIC PROFILE



A GRACEFUL TEAK STAIRCASE INVITES GUESTS TO EXPERIENCE THE SUNDECK, THE APEX OF OPEN-AIR PLEASURES



LIKE ANY TRUE ARTISTIC PURSUIT, DELTA'S DESIGNERS BEGAN WITH A SKETCH;
HOWEVER, KATYA IS THE MASTERWORK OF CLASSICAL NAVAL ARCHITECTURE TAKEN
TO NEW AND BEAUTIFUL LIMITS THANKS TO CUTTING-EDGE THREE-DIMENSIONAL
SURFACE MODELING TECHNOLOGY.





A FEAST FOR YOUR SENSES

When it comes to the art of alfresco dining, *Katya* is a gracious hostess. Her outdoor decks feature numerous expanses for taking full advantage of open-air pleasures. Whether it's formal dinners under the stars or casual luncheons during the height of day, sheltered outdoor dining options abound. Aft on the main and upper decks are two covered dining areas large enough to seat ten, featuring stately custom teak dining tables. Adjacent to the main salon and sky lounge, these sizable dining venues inspire the best of indoor and outdoor gatherings. Built in settees with comfortable, colorful cushions provide prime real estate to enjoy the view. Spacious walk-arounds and a handsome spiral staircase make traversing the decks easy, inviting all onboard to survey *Katya's* many stirring vistas.

TRUE ELEGANCE IS TIMELESS

STYLE

Step inside *Katya* and you can't help but feel that you've entered a breathtaking new world, one both familiar, yet different. Without question, it is a world of splendor. Hers is a spell that is reminiscent of a time when superior craftsmanship was the order of the day, and things were not just functional but gorgeous. *Katya*, while a thoroughly modern invention, takes her cues from the gilded past when a home spoke volumes about her occupants. Of this she is no exception. Her interiors are graciously welcoming, a fusion of sumptuous continental stylishness with touches of Jazz Age sophistication and spirit. It's a rare artistic mélange that can successfully suggest both a backward glance and extraordinary forward thinking. That's *Katya* a modern classic.

KATYA'S FOYERS ARE AWASH WITH SOPHISTICATION, HER FLOORS CRAFTED OF BRECCIA ONICIATA MARBLE WITH A ROSSO DAMASCO BORDER





BEGUILING BEAUTY

The Delta Design Group worked in collaboration with European designer Jean-Claude Canestrelli to invent an interior that is refined yet welcoming, perfect for glamorous evenings as well as cozy nights with family and friends. Masterly crafted woodwork defines *Katya's* interiors, with magnificent African Khaya mahogany and Cinamora framing every room and hallway. Exquisitely carved credenzas, cabinets and nightstands feature distinctive Crotch mahogany, polished to perfection. Accents of brushed nickel and gold joinery cast a soft, rich appearance.

KATYA'S GRAND CENTRAL STAIRCASE WITH A BRUSHED STAINLESS BALUSTRADE AND GRACEFUL KHAYA HANDRAIL EPITOMIZE HER CHARM AND CRAFTSMANSHIP





AN UNFORGETTABLE IMPRESSION

Welcoming guests at the handsome curved glass entrance to the main salon is a delightful marble inlay that reads "Katya" – informing all who enter you've certainly arrived. Just beyond the landing, a set of sophisticated bar cabinets await with refreshments. Large windows bring in natural light as well as provide a terrific vantage point for enjoying the view. Burgundy paisley upholstery mingles with updated French provincial plaid silks and sophisticated damask neutrals, brilliantly juxtaposed with accents of teal. Glass art displays divide the main salon from the dining salon where a polished mahogany dining table invites guests to dinner.

ON THE UPPER DECK, THE SKYLounge IS THE PERFECT PLACE FOR CASUAL FUN DURING THE DAY AND STYLISH COCKTAILS AT NIGHT, FEATURING A STATELY FULL BAR TOPPED IN OPERA FANTISTICO MARBLE





STATELY SOPHISTICATION REIGNS SUPREME

RETREAT

Throughout *Katya*, her grace never fails to impress. Nowhere is the attention to detail more splendid or personal than in her master suite and her four guest suites. The hallway and foyer connecting the guest suites is a work of art all of its own, with a hand-laid Breccia Oniciata marble floor with a Rosso Damasco border. In the midst of this lavish passageway, a lovely Tiger Eye mosaic inlay provides the perfect stage for fresh flower displays.



ONE OF KATYA'S UNFORGETTABLE DESIGN ELEMENTS IS HER IMPRESSIVE STONEMARK, INCLUDING A GENEROUS USE OF ONYX AND MARBLE. RAINFOREST GREEN AND GALAXY BLACK MARBLES ARE UNIQUE TO THE DAY HEADS



AN EXCLUSIVE GETAWAY

On the main level, the handsome mahogany woodwork continues, and frames *Katya's* full beam master suite. Here, her owners can enjoy the ideal private getaway to wind down after active days on the ocean. The room is spacious, relaxing and ultimately functional thanks to an impressive abundance of storage. The thoughtful his and her desks provide her owners the right amount of personal space in this luxurious sanctuary. Large windows bring in the glorious early morning light and allow for private stargazing.



LUXURIOUSLY ACCOMMODATING

In each of the heads, a wide array of onyx immediately communicates the elegance of *Katya* down to the finest detail. Each guest suite has its own color scheme that corresponds to the countertops and accents used in the heads, including green, white, and a very rare pink onyx. Like the main living spaces, the guest areas will feature warm, soothing neutral colors, satin finishes, Novasuede overheads and soft upholstered wall panels.

THE MASTER HEAD FEATURES A SUPREMELY
OPULENT PLAY OF ONYX AND MARBLE WORK





A built-in desk provides a useful place to catch up on correspondence and journal, while the rounded corner king size bed offers lavish comfort. Oversized windows fill this tranquil oasis with sunlight during the day and bring in the enchantment of starry nights at sea.

THE TIGER EYE MOSAIC INLAY WELCOMES GUESTS
TO THE TRANQUIL AND SUMPTUOUS LOWER DECK





A WORKING WORK OF ART

Katya is a wonder of form as well as function, which is particularly evident in her crew and working spaces. The well-equipped galley features Labradorite granite countertops, four commercial grade refrigerator/freezers, an ample butler's pantry and generous storage for dry goods. She also has a convenient second staircase to provide access for the crew from the galley to the upper deck. Another smart detail is the captain's quarters are located aft of the wheelhouse on the upper deck. All the crew areas are bright and cheerful, using lighter woods and durable wall coverings. No matter how you experience *Katya*, her thoughtful details and superior craftsmanship ensure it will be an unforgettable pleasure.

EACH GUEST SUITE IS DECORATED WITH ITS OWN
UNIQUE COLOR SCHEME, DOWN TO THE POLISHED
STONEMARK IN THE WELL-APPOINTED HEADS



FROM HER BEGUILING PROFILE AND SCULPTURAL CONTOURS TO HER STATE-OF-THE-ART UNDERPINNINGS, KATYA IS A WORK OF ART COMPLETELY DISTINCTIVE AND UNFORGETTABLE.





A MARVEL OF INGENUITY

One of *Katya's* many technical innovations is her proprietary tender launching system and garage. Since it was the owners' desire to carry as large a tender as possible onboard, the Delta Design Group created a solution that maximized the available storage space. Understanding that a traditional overhead crane system would have taken too much space, they created a fully hydraulic articulating trailer system for launching and recovering the tender. Using a series of rollers, this solution features a specially designed and built captive reel winch that eases out the bow line, and allows the tender to slip gently into the water via the mechanical transom door. The amazing feat of this custom built stainless steel deployment system is that a 3,000 lb tender can be lowered into the water and projected over the dive platform without ever touching it, swiftly and effortlessly – in less than five minutes from start to finish.



LOA	151'46 meters
LWL	134' 5"/41 meters
Beam	30' 8"/9.3 meters (molded) 31' 8"/9.7 meters (extreme)
Draft	9' 2"/2.8 meters (half load) 9' 7"/2.9 meters (full load)
Displacement	427 long tons (half load) 451 long tons (full load)
Gross Tonnage	472 ITC
Engines	2 x CAT 3508B 1,000 BHp @ 1,600 rpm
Speed	15.5 knots
Cruise	12.5 knots
Fuel capacity	20,780 US gallons/78,661 liters
Range	5,000 nautical miles @ 12 knots
Fresh water capacity	3,000 US gallons / 11,356 liters
Generators	(2) Northern Lights 130 kW
Stabilizers	Quantum QC-1800 Zero Speed
Material	Composite
Owner and guests	12
Crew	10
Classification	Lloyd's Register 100 Maltese Cross A1 SSC Yacht Mono G6 MCH, MCA
Naval architecture	Delta Design Group
Exterior styling	Delta Design Group
Interior space planning	Delta Design Group
Interior design	Delta Design Group Jean Claude Canestrelli
Builder / Year	Delta/2009

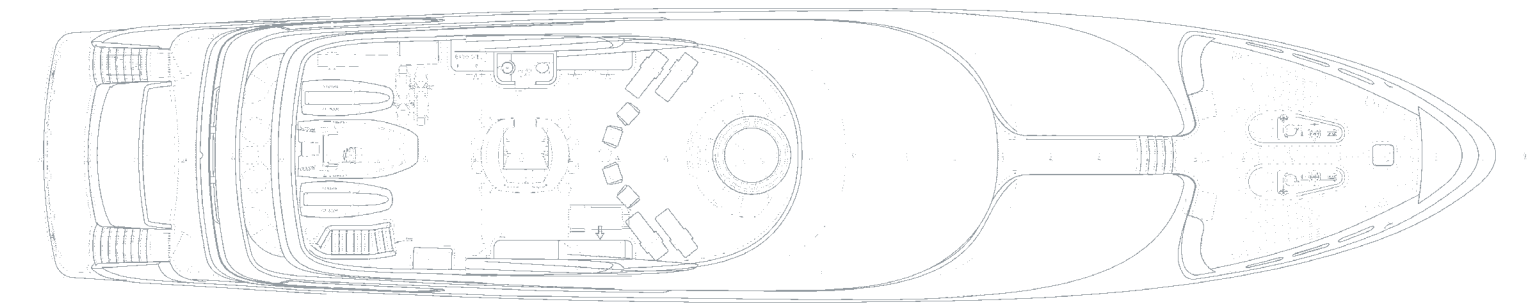

SUN DECK

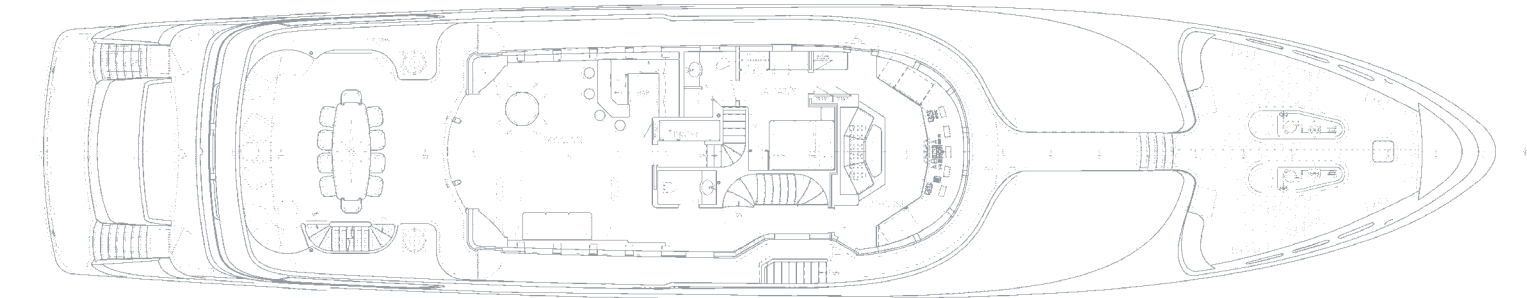

UPPER DECK

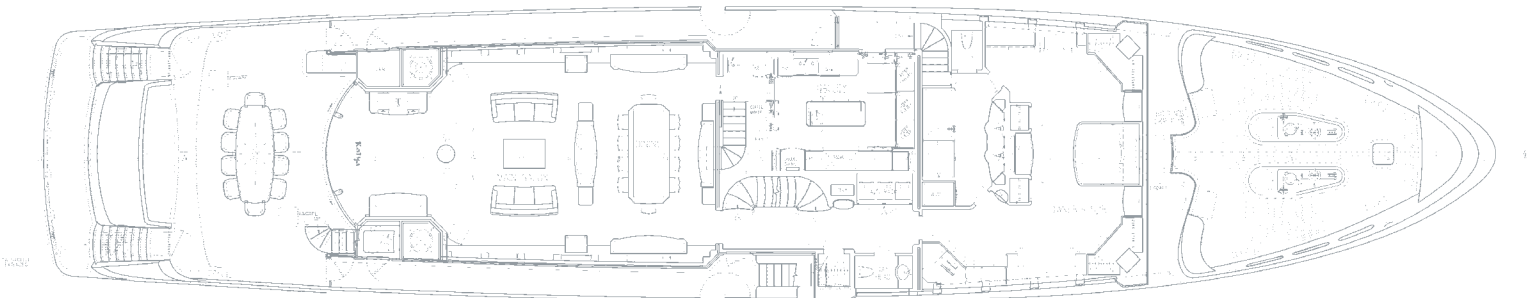

MAIN DECK

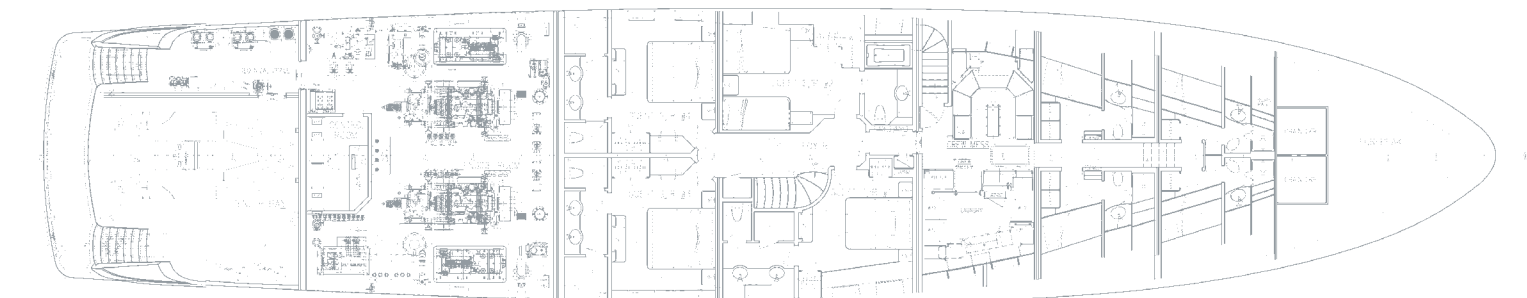

LOWER DECK

